

1C3YX – Sealing Head

Light Series – Metric Swivel Nut

Material: Steel

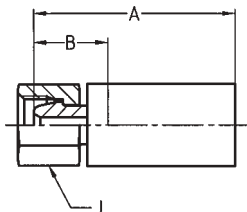

YX Series

Part No. #	DN size mm inch				Connection Type Thread Size	A mm	B mm	J mm
1C3YX-6-03	5	-03	4.8	3/16	M12x1.5	43	18	14
1C3YX-8-03	5	-03	4.8	3/16	M14x1.5	43	18	17
1C3YX-10-03	5	-03	4.8	3/16	M16x1.5	43	18	19
1C3YX-8-04	6	-04	6.4	1/4	M14x1.5	46	18	17
1C3YX-10-04	6	-04	6.4	1/4	M16x1.5	46	18	19
1C3YX-10-05	8	-05	7.9	5/16	M16x1.5	46	18	19
1C3YX-10-06	10	-06	9.5	3/8	M16x1.5	49	20	22
1C3YX-12-06	10	-06	9.5	3/8	M18x1.5	48	19	22
1C3YX-12-08	12	-08	12.7	1/2	M18x1.5	52	20	24
1C3YX-15-08	12	-08	12.7	1/2	M22x1.5	51	20	27
1C3YX-18-10	16	-10	15.9	5/8	M26x1.5	51	20	32
1C3YX-18-12	20	-12	19.0	3/4	M26x1.5	57	22	32
1C3YX-22-12	20	-12	19.0	3/4	M30x2	57	23	36
1C3YX-28-16	25	-16	25.4	1	M36x2	59	25	41

Material: Steel, surface protection according to DIN 50 961 Fe/Zn, stainless steel (1.4571) fittings available on request.

Nipple: Stainless Steel

Part No. #	DN size mm inch				Connection Type Thread Size	A mm	B mm	J mm
1C3YX-6-03 C2W	5	-03	4.8	3/16	M12x1.5	43	18	14
1C3YX-8-03 C2W	5	-03	4.8	3/16	M14x1.5	43	18	17
1C3YX-10-03 C2W	5	-03	4.8	3/16	M16x1.5	43	18	19
1C3YX-8-04 C2W	6	-04	6.4	1/4	M14x1.5	46	18	17
1C3YX-10-04 C2W	6	-04	6.4	1/4	M16x1.5	46	18	19
1C3YX-10-05 C2W	8	-05	7.9	5/16	M16x1.5	46	18	19
1C3YX-10-06 C2W	10	-06	9.5	3/8	M16x1.5	49	20	22
1C3YX-12-06 C2W	10	-06	9.5	3/8	M18x1.5	48	19	22
1C3YX-12-08 C2W	12	-08	12.7	1/2	M18x1.5	52	20	24
1C3YX-15-08 C2W	12	-08	12.7	1/2	M22x1.5	51	20	27

Material: Steel, surface protection according to DIN 50 961 Fe/Zn, C2W includes stainless steel nipple (material 1.4301).