

LF 3000® Push-In Fittings / Banjo Fittings



A modular solution designed to orientate the tube according to the application.

Ø metric:
4 to 12 mm

Technical Characteristics

- **Compatible Fluids:** Compressed air
Other fluids: please consult us
- **Working Pressure:** Vacuum to 20 bar
- **Working Temperature:** -20°C to +80°C

| Tightening Torque (daN.m) | Threads | | | | | |
|---------------------------------|------------|------------|------|------|------|------|
| | M3 x0.5 | M5 x0.8 | G1/8 | G1/4 | G3/8 | G1/2 |
| | 0.05 | 0.1 | 0.4 | 0.5 | 0.6 | 0.7 |

Reliable performance is dependent upon the type of fluid conveyed, component materials and tubing being used.

Use is guaranteed with a vacuum of 755 mm Hg (99% vacuum).

Advantages

- Screwed from above, for minimum space between connections
- 360° orientable
- Stacking of banjo bodies to allow construction of 2 to 6 outlets

Component Materials

Silicone-free

Bolt: nickel-plated brass, with or without pre-coating, depending on the configuration

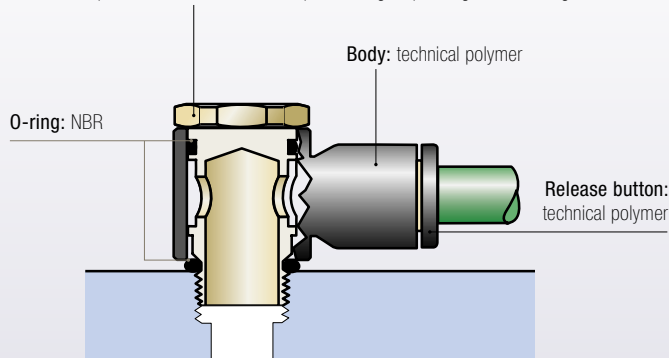

Regulations

- ISO 14743
- PED
- RoHS
- REACH

Installation Configurations

Thread and bore diameters for part numbers 3524 - 3527 - 3528 - 3529:

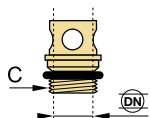

| Thread (C) | M5x0.8 | G1/8 | G1/4 | G3/8 | G1/2 |
|------------|--------|------|------|------|------|
| ØD | 2.5 | 5.5 | 8.5 | 11 | 13 |

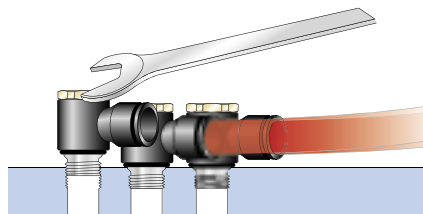

3118 Single Banjo, Male BSPP and Metric Thread

Technical polymer, Nickel-plated brass, NBR

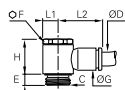

| ØD | C | | E | F | G | H | L1 | L2 | Kg |
|----|--------|--------------------|-----|----|------|------|------|------|-------|
| 3 | M3x0.5 | 3118 03 09* | 3 | - | 8.5 | 13 | 5 | 16 | 0.005 |
| 4 | M5x0.8 | 3118 04 19* | 4 | - | 8.5 | 13 | 5 | 16.5 | 0.004 |
| | G1/8 | 3118 04 10 | 4 | 13 | 8.5 | 17 | 7 | 18.5 | 0.012 |
| 6 | M5x0.8 | 3118 06 19* | 4 | - | 10.5 | 13 | 7 | 18.5 | 0.004 |
| | G1/8 | 3118 06 10 | 4 | 13 | 10.5 | 17 | 7 | 20 | 0.013 |
| | G1/4 | 3118 06 13 | 5.5 | 17 | 10.5 | 21 | 9.5 | 22 | 0.023 |
| | G1/8 | 3118 08 10 | 4 | 13 | 13.5 | 16.5 | 7 | 25 | 0.014 |
| 8 | G1/4 | 3118 08 13 | 5.5 | 17 | 13.5 | 21 | 9 | 27 | 0.024 |
| | G3/8 | 3118 08 17 | 5.5 | 20 | 13.5 | 24.5 | 11 | 29 | 0.038 |
| | G1/4 | 3118 10 13 | 5.5 | 17 | 16 | 21 | 9.5 | 29 | 0.025 |
| | G3/8 | 3118 10 17 | 5.5 | 20 | 16 | 24.5 | 11 | 31 | 0.039 |
| 10 | G1/2 | 3118 10 21 | 8 | 25 | 19 | 27.5 | 13.5 | 36.5 | 0.083 |
| | G3/8 | 3118 12 17 | 5.5 | 20 | 19 | 24.5 | 11 | 34.5 | 0.040 |
| 12 | G1/2 | 3118 12 21 | 8 | 25 | 19 | 27.5 | 13.5 | 36.5 | 0.075 |

*With screwdriver slot

3018 Single Banjo, Male BSPT Thread

Technical polymer, Nickel-plated brass, NBR

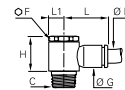

| ØD | C | | F | G | H | L | L1 | Kg |
|----|------|-------------------|----|------|------|------|-----|-------|
| 6 | R1/8 | 3018 06 10 | 13 | 10.5 | 18.5 | 20 | 7 | 0.015 |
| | R1/4 | 3018 06 13 | 17 | 10.5 | 22.5 | 22 | 9.5 | 0.029 |
| 8 | R1/8 | 3018 08 10 | 13 | 13.5 | 18.5 | 25 | 7 | 0.016 |
| | R1/4 | 3018 08 13 | 17 | 13.5 | 22.5 | 27 | 9.5 | 0.030 |
| 10 | R1/4 | 3018 10 13 | 17 | 16 | 22.5 | 29 | 9.5 | 0.031 |
| | R3/8 | 3018 10 17 | 21 | 16 | 26.5 | 31 | 11 | 0.048 |
| 12 | R1/4 | 3018 12 13 | 21 | 19 | 26.5 | 34.5 | 11 | 0.052 |
| | R3/8 | 3018 12 17 | 21 | 19 | 26.5 | 34.5 | 11 | 0.050 |

Pre-coated thread

LF 3000® Push-In Fittings / Banjo Fittings

3124 Single Banjo, Male/Female BSPP and Metric Thread

Technical polymer, Nickel-plated brass, NBR

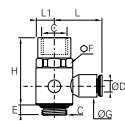

| ØD | C | | E | F | G | H | L | L1 | Kg |
|----|------|-------------------|-----|----|------|------|------|----|-------|
| 4 | G1/8 | 3124 04 10 | 4 | 13 | 8.5 | 25.5 | 18.5 | 7 | 0.015 |
| 6 | G1/4 | 3124 06 13 | 5.5 | 17 | 10.5 | 33 | 22 | 9 | 0.029 |
| 8 | G3/8 | 3124 08 17 | 5.5 | 20 | 13.5 | 37.5 | 29 | 11 | 0.043 |

This product family was developed to allow assembly of a function fitting on a cylinder.

3538 Single Banjo Bodies

Technical polymer, NBR

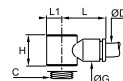

| ØD | C | | G | H | L | L1 | Kg |
|----|--------|-------------------|------|------|------|------|-------|
| 4 | M5x0.8 | 3538 04 19 | 8.5 | 13 | 16 | 5 | 0.001 |
| | G1/8 | 3538 04 10 | 10.5 | 14.5 | 18.5 | 7 | 0.002 |
| | M5x0.8 | 3538 06 19 | 11 | 13 | 18.5 | 5 | 0.002 |
| 6 | G1/8 | 3538 06 10 | 10.5 | 14.5 | 20 | 7 | 0.002 |
| | G1/4 | 3538 06 13 | 13.5 | 18 | 22 | 9.5 | 0.003 |
| | G1/8 | 3538 08 10 | 13.5 | 14.5 | 25 | 7 | 0.003 |
| 8 | G1/4 | 3538 08 13 | 13.5 | 18 | 27 | 9.5 | 0.004 |
| | G3/8 | 3538 08 17 | 13.5 | 21.5 | 29 | 11.5 | 0.005 |
| | G1/4 | 3538 10 13 | 16 | 18 | 29 | 9.5 | 0.005 |
| 10 | G3/8 | 3538 10 17 | 16 | 21.5 | 31 | 11.5 | 0.006 |
| 12 | G3/8 | 3538 12 17 | 19 | 21.5 | 34.5 | 11.5 | 0.008 |

3149 Twin Banjo, Male BSPP and Metric Thread

Technical polymer, Nickel-plated brass, NBR

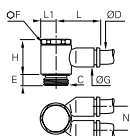

| ØD | C | | E | F | G | H | L | L1 | N | Kg |
|----|--------|--------------------|-----|----|------|------|------|-----|------|-------|
| 4 | M5x0.8 | 3149 04 19* | 4 | | 8.5 | 13 | 16 | 4.5 | 9 | 0.005 |
| | G1/8 | 3149 04 10 | 4 | 13 | 10.5 | 16.5 | 18.5 | 7 | 11.5 | 0.018 |
| 6 | G1/8 | 3149 06 10 | 4 | 13 | 10.5 | 16.5 | 18.5 | 7 | 11.5 | 0.014 |
| | G1/4 | 3149 06 13 | 5.5 | 17 | 13.5 | 21 | 27 | 9.5 | 14.5 | 0.035 |
| | G1/4 | 3149 08 13 | 5.5 | 17 | 13.5 | 21 | 27 | 9.5 | 14.5 | 0.026 |
| 8 | G3/8 | 3149 08 17 | 5.5 | 20 | 16 | 24.5 | 31 | 11 | 17 | 0.053 |
| 10 | G3/8 | 3149 10 17 | 5.5 | 20 | 16 | 24.5 | 31 | 11 | 17 | 0.042 |

*With screwdriver slot

3539 Double Banjo Bodies

Technical polymer, NBR

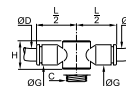

| ØD | C | | G | H | L/2 | Kg |
|----|------|-------------------|------|------|------|-------|
| 6 | G1/8 | 3539 06 10 | 10.5 | 14.3 | 20 | 0.011 |
| | G1/4 | 3539 06 13 | 13.5 | 18 | 26 | 0.015 |
| 8 | G1/4 | 3539 08 13 | 13.5 | 18 | 27 | 0.005 |
| | G3/8 | 3539 08 17 | 16 | 21.5 | 30.5 | 0.020 |
| 10 | G3/8 | 3539 10 17 | 16 | 21.5 | 31 | 0.008 |

3119 Double Banjo, BSPP and Metric Thread

Technical polymer, Nickel-plated brass, NBR

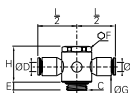

| ØD | C | | E | F | G | H | L/2 | Kg |
|----|--------|--------------------|-----|----|------|------|------|-------|
| 4 | M5x0.8 | 3119 04 19* | 4 | | 8.5 | 13 | 8 | 0.005 |
| | G1/8 | 3119 06 10 | 4 | 13 | 11 | 17 | 20 | 0.014 |
| 6 | G1/4 | 3119 06 13 | 5.5 | 17 | 13.5 | 21 | 26.5 | 0.035 |
| | G1/4 | 3119 08 13 | 5.5 | 17 | 13.5 | 21 | 27 | 0.026 |
| 8 | G3/8 | 3119 08 17 | 5.5 | 20 | 16 | 24.5 | 30.5 | 0.053 |

*With screwdriver slot

3549 Twin Banjo Bodies

Technical polymer, NBR

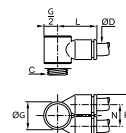

| ØD | C | | G | K | L | N | Kg |
|----|--------|-------------------|------|------|------|------|-------|
| 4 | M5x0.8 | 3549 04 19 | 10 | 17.5 | 15.5 | 9 | 0.003 |
| | G1/4 | 3549 04 13 | 18.5 | 28 | 25 | 14.5 | 0.020 |
| | G1/8 | 3549 06 10 | 14 | 22.5 | 20.5 | 12 | 0.003 |
| 6 | G1/4 | 3549 06 13 | 18.5 | 28 | 25 | 14.5 | 0.015 |
| | G3/8 | 3549 06 17 | 22.5 | 33 | 28.5 | 17 | 0.031 |
| | G1/4 | 3549 08 13 | 18.5 | 28 | 26 | 14.5 | 0.006 |
| 8 | G3/8 | 3549 08 17 | 22.5 | 33 | 29.5 | 17 | 0.020 |
| 10 | G3/8 | 3549 10 17 | 22.5 | 33 | 29.5 | 17 | 0.009 |

3527 Single Banjo Bolts, Male BSPP and Metric Thread

Nickel-plated brass, NBR

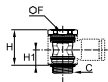

| C | | F | H | H1 | Kg |
|--------|--------------------|----|------|-----|-------|
| M5x0.8 | 3527 00 19* | | 17 | 7.5 | 0.003 |
| G1/8 | 3527 00 10 | 13 | 17 | 7.5 | 0.011 |
| G1/4 | 3527 00 13 | 17 | 21 | 9.5 | 0.020 |
| G3/8 | 3527 00 17 | 20 | 24.5 | 11 | 0.033 |

*With screwdriver slot
Full bore

3529 Stacking Banjo for 3 Body High Modules, Male BSPP Thread

Nickel-plated brass, NBR

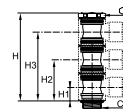

| C | | F | H | H1 | H2 | H3 | Kg |
|------|-------------------|----|------|-----|------|------|-------|
| G1/8 | 3529 00 10 | 13 | 45.5 | 7.5 | 22 | 36 | 0.023 |
| G1/4 | 3529 00 13 | 17 | 54 | 9.5 | 27.5 | 45.5 | 0.042 |
| G3/8 | 3529 00 17 | 20 | 67.5 | 11 | 32.5 | 54 | 0.069 |

Full bore
Designed for use with 3 banjo bodies

3528 Stacking Banjo for 2 Body High Modules, Male BSPP and Metric Thread

Nickel-plated brass, NBR

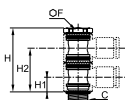

| C | | F | H | H1 | H2 | Kg |
|--------|--------------------|------|-----|------|-------|-------|
| M5x0.8 | 3528 00 19* | 24.5 | 7.5 | 18.5 | 0.005 | |
| G1/8 | 3528 00 10 | 13 | 31 | 7.5 | 22 | 0.017 |
| G1/4 | 3528 00 13 | 17 | 39 | 9.5 | 27.5 | 0.031 |
| G3/8 | 3528 00 17 | 20 | 46 | 11 | 32.5 | 0.053 |

*With screwdriver slot
Full bore
Designed for use with 2 banjo bodies

3524 Threaded Banjo Bolts, Male/Female BSPP and Metric Thread

Nickel-plated brass, NBR

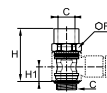

| C | | F | H | H1 | Kg |
|------|-------------------|----|------|------|-------|
| G1/8 | 3524 00 10 | 13 | 24.5 | 7.5 | 0.013 |
| G1/4 | 3524 00 13 | 17 | 33 | 9.5 | 0.027 |
| G3/8 | 3524 00 17 | 20 | 37.5 | 11 | 0.039 |
| G1/2 | 3524 00 21 | 26 | 42 | 11.5 | 0.067 |

Full bore

Banjo bolts 3527, 3528, 3529 and 3524 are only usable in association with the corresponding bodies for modular construction 3538, 3539 and 3549.

Thread and passage size for part numbers 3527, 3528, 3529 and 3524.

| Thread | M5x0.8 | G1/8 | G1/4 | G3/8 | G1/2 |
|--------|--------|------|------|------|------|
| | 2.5 | 5.5 | 8.5 | 11 | 13 |

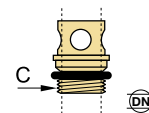

LF 3000® Push-In Fittings / Tube-to-Tube Fittings

3106 Equal and Unequal Tube-to-Tube Connector

Technical polymer, NBR

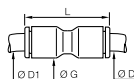

| ØD | ØD1 | | G | L | Kg |
|----|-----|-------------------|------|------|-------|
| 3 | 3 | 3106 03 00 | 8.5 | 25 | 0.002 |
| | 4 | 3106 03 04 | 8.5 | 25 | 0.002 |
| | 1/4 | 3106 04 56 | 11 | 29.5 | 0.005 |
| 4 | 4 | 3106 04 00 | 8.5 | 25 | 0.001 |
| | 6 | 3106 04 06 | 11 | 28 | 0.002 |
| | 8 | 3106 04 08 | 13.5 | 38 | 0.005 |
| 6 | 1/4 | 3106 06 56 | 13.5 | 36 | 0.009 |
| | 6 | 3106 06 00 | 10.5 | 28.5 | 0.002 |
| | 8 | 3106 06 08 | 13.5 | 38 | 0.005 |
| 8 | 10 | 3106 06 10 | 16 | 42 | 0.008 |
| | 8 | 3106 08 00 | 13.5 | 38 | 0.004 |
| | 10 | 3106 08 10 | 16 | 42 | 0.007 |
| 10 | 12 | 3106 08 12 | 19 | 50.5 | 0.026 |
| | 10 | 3106 10 00 | 16 | 42 | 0.005 |
| | 12 | 3106 10 12 | 19 | 50.5 | 0.018 |
| 12 | 1/2 | 3106 12 62 | 22 | 56.5 | 0.041 |
| | 12 | 3106 12 00 | 19 | 50.5 | 0.009 |
| | 14 | 3106 12 14 | 22 | 56 | 0.025 |
| 14 | 16 | 3106 12 16 | 27 | 61 | 0.066 |
| | 14 | 3106 14 00 | 22 | 56 | 0.014 |
| 16 | 16 | 3106 16 00 | 27 | 60.5 | 0.041 |

3106 Equal and Unequal Tube-to-Tube Connector Inch

Technical polymer, NBR

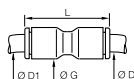

| ØD | ØD1 | | G | L | Kg |
|-----|-----|-------------------|----|------|-------|
| 1/4 | 1/4 | 3106 56 00 | 11 | 29.5 | 0.002 |
| | 3/8 | 3106 60 00 | 16 | 42 | 0.006 |
| 3/8 | 10 | 3106 60 10 | 12 | 50.5 | 0.028 |
| | 1/4 | 3106 60 56 | 16 | 41 | 0.016 |
| 1/2 | 1/2 | 3106 62 00 | 22 | 55 | 0.016 |

5/32"(4 mm) and 5/16"(8 mm) also available

3102 Equal and Unequal Elbow

Technical polymer, NBR

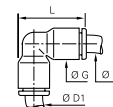

| ØD | ØD1 | | G | L | Kg |
|----|-----|-------------------|------|------|-------|
| 4 | 4 | 3102 04 00 | 8.5 | 19 | 0.001 |
| | 6 | 3102 04 06 | 10.5 | 22.5 | 0.003 |
| 6 | 6 | 3102 06 00 | 10.5 | 22.5 | 0.002 |
| | 8 | 3102 06 08 | 13.5 | 29.5 | 0.008 |
| 8 | 8 | 3102 08 00 | 13.5 | 29.5 | 0.004 |
| | 10 | 3102 08 10 | 16 | 34.5 | 0.011 |
| 10 | 10 | 3102 10 00 | 16 | 34.5 | 0.006 |
| | 12 | 3102 10 12 | 19 | 40.5 | 0.019 |
| 12 | 12 | 3102 12 00 | 19 | 40.5 | 0.010 |
| 14 | 14 | 3102 14 00 | 22 | 46.5 | 0.015 |
| 16 | 16 | 3102 16 00 | 27 | 52 | 0.043 |

3102 Equal and Unequal Elbow Inch

Technical polymer, NBR

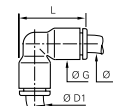

| ØD | ØD1 | | G | L | Kg |
|-----|-----|-------------------|----|-----|-------|
| 1/4 | 1/4 | 3102 56 00 | 11 | 2.5 | 0.002 |
| 3/8 | 3/8 | 3102 60 00 | 16 | 34 | 0.006 |
| 1/2 | 1/2 | 3102 62 00 | 22 | 35 | 0.017 |

5/32"(4 mm) and 5/16"(8 mm) also available

3104 Equal and Unequal Tee

Technical polymer, NBR

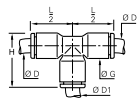

| ØD | ØD1 | | G | H | L/2 | Kg |
|----|-----|-------------------|------|------|------|-------|
| 3 | 3 | 3104 03 00 | 8.5 | 19 | 14.5 | 0.004 |
| 4 | 4 | 3104 04 00 | 8.5 | 19 | 14.5 | 0.002 |
| | 6 | 3104 04 06 | 10.5 | 22.5 | 17.5 | 0.007 |
| 6 | 4 | 3104 06 04 | 10.5 | 22.5 | 17.5 | 0.005 |
| | 6 | 3104 06 00 | 10.5 | 22.5 | 17.5 | 0.003 |
| 8 | 8 | 3104 06 08 | 13.5 | 29.5 | 23 | 0.015 |
| | 4 | 3104 08 04 | 13.5 | 29 | 17.5 | 0.013 |
| 8 | 6 | 3104 08 06 | 13.5 | 29.5 | 23 | 0.010 |
| | 8 | 3104 08 00 | 13.5 | 29.5 | 23 | 0.006 |
| 10 | 10 | 3104 08 10 | 16 | 34.5 | 26.5 | 0.020 |
| | 4 | 3104 10 04 | 16 | 33 | 26 | 0.023 |
| 10 | 8 | 3104 10 08 | 16 | 34.5 | 26.5 | 0.014 |
| | 10 | 3104 10 00 | 16 | 34.5 | 26.5 | 0.009 |
| 12 | 12 | 3104 10 12 | 19 | 40.5 | 31 | 0.033 |
| | 4 | 3104 12 04 | 19 | 39 | 31 | 0.040 |
| 12 | 10 | 3104 12 10 | 19 | 40.5 | 31 | 0.023 |
| | 12 | 3104 12 00 | 19 | 40.5 | 31 | 0.014 |
| 14 | 8 | 3104 14 08 | 22 | 46 | 35.5 | 0.054 |
| | 14 | 3104 14 00 | 22 | 46 | 35.5 | 0.022 |
| 16 | 12 | 3104 16 12 | 27 | 52.5 | 39 | 0.088 |
| | 16 | 3104 16 00 | 27 | 52 | 39 | 0.063 |

3104 Equal and Unequal Tee

Inch

Technical polymer, NBR

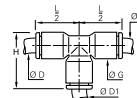

| ØD | ØD1 | | G | H | L/2 | Kg |
|------|------|-------------------|------|------|------|-------|
| 5/32 | 1/4 | 3104 04 56 | 11 | 23.5 | 18 | 0.008 |
| 1/8 | 1/8 | 3104 53 00 | 8.4 | 19 | 14.5 | 0.003 |
| | 1/4 | 3104 53 56 | 11 | 23.5 | 18 | 0.011 |
| 3/16 | 3/16 | 3104 55 00 | 11 | 27.2 | 21.6 | 0.016 |
| | 5/32 | 3104 56 04 | 11 | 23.5 | 18.5 | 0.014 |
| 1/4 | 1/4 | 3104 56 00 | 11 | 23 | 24 | 0.003 |
| | 1/8 | 3104 56 53 | 11 | 23.5 | 18.5 | 0.007 |
| 3/8 | 3/8 | 3104 56 60 | 16 | 33.5 | 24.5 | 0.017 |
| | 1/4 | 3104 60 56 | 16 | 32.5 | 25.5 | 0.019 |
| 1/2 | 3/8 | 3104 60 00 | 16 | 34 | 26 | 0.009 |
| | 1/2 | 3104 62 00 | 22 | 46 | 35 | 0.026 |
| 1/2 | 1/4 | 3104 62 56 | 22.1 | 45.2 | 35.3 | 0.059 |
| | 3/8 | 3104 62 60 | 22 | 46 | 35 | 0.047 |

5/32"(4 mm) and 5/16"(8 mm) also available

3140 Equal and Unequal Single Y Piece

Technical polymer, NBR

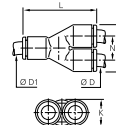

| ØD | ØD1 | | H | K | L | N | Kg |
|----|-----|-------------------|------|------|------|------|-------|
| 4 | 4 | 3140 04 00 | 17.5 | 8.5 | 28.5 | 9 | 0.002 |
| | 6 | 3140 04 06 | 17.5 | 10.5 | 33 | 9 | 0.002 |
| 6 | 6 | 3140 06 00 | 21.5 | 10.5 | 35 | 11 | 0.004 |
| | 8 | 3140 06 08 | 22.5 | 13.5 | 41 | 11.5 | 0.005 |
| 8 | 8 | 3140 08 00 | 28 | 13.5 | 45 | 14.5 | 0.006 |
| | 10 | 3140 08 10 | 28 | 16 | 47 | 14.5 | 0.008 |
| 10 | 10 | 3140 10 00 | 33 | 16 | 53 | 17 | 0.010 |
| | 12 | 3140 10 12 | 33 | 19 | 57 | 17 | 0.012 |
| 12 | 12 | 3140 12 00 | 39 | 19 | 57 | 20 | 0.017 |

3107 Equal and Unequal Cross

Technical polymer, NBR

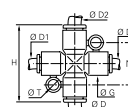

| ØD | ØD1 | ØD2 | | G | H | N | ØT | Kg |
|----|-----|-----|-------------------|------|----|------|-----|-------|
| 4 | 4 | 4 | 3107 04 00 | 11 | 36 | 20 | 4.2 | 0.014 |
| 6 | 4 | 6 | 3107 04 06 | 11 | 36 | 20 | 4.2 | 0.009 |
| 4 | 4 | 6 | 3107 06 04 | 11 | 36 | 20 | 4.2 | 0.011 |
| 6 | 6 | 6 | 3107 06 00 | 11 | 36 | 20 | 4.2 | 0.005 |
| 8 | 6 | 8 | 3107 06 08 | 11 | 46 | 22.5 | 4.2 | 0.018 |
| 6 | 6 | 8 | 3107 08 06 | 13.5 | 46 | 22.5 | 4.2 | 0.022 |
| 8 | 8 | 8 | 3107 08 00 | 13.5 | 46 | 22.5 | 4.2 | 0.009 |

LF 3000® Push-In Fittings / Bulkhead Connector Fittings

3116 Equal Bulkhead Connector

Technical polymer, NBR

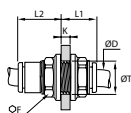

| ØD | | F | K max | L1 | L2 | ØT min | Kg |
|----|-------------------|----|-------|------|------|--------|-------|
| 4 | 3116 04 00 | 13 | 5.5 | 15 | 10 | 10.5 | 0.003 |
| 6 | 3116 06 00 | 15 | 8 | 19 | 11.5 | 12.5 | 0.004 |
| 8 | 3116 08 00 | 18 | 14.5 | 25 | 13.5 | 15.5 | 0.007 |
| 10 | 3116 10 00 | 22 | 14.5 | 27.5 | 15.5 | 18.5 | 0.011 |
| 12 | 3116 12 00 | 26 | 18.5 | 33 | 18 | 22.5 | 0.019 |
| 14 | 3116 14 00 | 29 | 20.5 | 37.5 | 20.5 | 25.5 | 0.028 |

3136 Bulkhead Connector, Female BSPP Thread

Nickel-plated brass, NBR

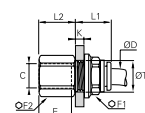

| ØD | C | | E | F1 | F2 | K max | L1 | L2 | ØT min | Kg |
|----|------|-------------------|------|----|----|-------|------|------|--------|-------|
| 4 | G1/8 | 3136 04 10 | 9.5 | 13 | 13 | 7 | 17 | 11.5 | 10.5 | 0.015 |
| | G1/4 | 3136 04 13 | 13.5 | 13 | 16 | 7 | 17 | 15.5 | 10.5 | 0.021 |
| 6 | G1/8 | 3136 06 10 | 9.5 | 15 | 15 | 8 | 19 | 10.5 | 12.5 | 0.021 |
| | G1/4 | 3136 06 13 | 13.5 | 15 | 17 | 7 | 19 | 15.5 | 12.5 | 0.027 |
| 8 | G3/8 | 3136 06 17 | 12 | 15 | 22 | 8 | 19 | 16 | 12.5 | 0.041 |
| | G1/8 | 3136 08 10 | 9.5 | 18 | 17 | 8 | 20.5 | 10.5 | 15.5 | 0.029 |
| 10 | G1/4 | 3136 08 13 | 13.5 | 18 | 17 | 8 | 20.5 | 14.5 | 15.5 | 0.029 |
| | G3/8 | 3136 10 17 | 14 | 22 | 22 | 8.5 | 23 | 16 | 18.5 | 0.050 |
| 12 | G3/8 | 3136 12 17 | 14 | 26 | 24 | 8.5 | 27 | 16 | 22.5 | 0.079 |
| | G1/2 | 3136 12 21 | 19.5 | 26 | 27 | 8.5 | 27 | 21.5 | 22.5 | 0.098 |
| 16 | G3/8 | 3136 16 17 | 12 | 29 | 29 | 10.5 | 30 | 15 | 27.5 | 0.125 |
| | G1/2 | 3136 16 21 | 15 | 29 | 29 | 10.5 | 30 | 19.5 | 27.5 | 0.126 |

3146 Equal Mixed Bulkhead Connector

Nickel-plated brass, NBR

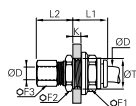

| ØD | | F1 | F2 | F3 | K max | L1 | L2 | ØT min | Kg |
|----|-------------------|----|----|----|-------|------|------|--------|-------|
| 4 | 3146 04 00 | 13 | 13 | 10 | 7 | 17.5 | 17.5 | 10.5 | 0.018 |
| 6 | 3146 06 00 | 15 | 17 | 13 | 8 | 19 | 18 | 12.5 | 0.028 |
| 8 | 3146 08 00 | 18 | 19 | 14 | 8 | 20.5 | 20.5 | 15.5 | 0.036 |
| 10 | 3146 10 00 | 22 | 22 | 19 | 8.5 | 23 | 24.5 | 18.5 | 0.062 |
| 12 | 3146 12 00 | 26 | 25 | 22 | 8.5 | 27 | 25 | 22.5 | 0.095 |
| 14 | 3146 14 00 | 29 | 29 | 24 | 10.5 | 27 | 27 | 25.5 | 0.124 |

Push-in connection with compression fitting

3139 Equal Bulkhead Elbow

Technical polymer, Nickel-plated brass, NBR

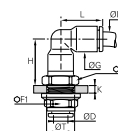

| ØD | | F | F1 | G | H | K max | L | ØT min | Kg |
|----|-------------------|----|----|------|------|-------|------|--------|-------|
| 4 | 3139 04 00 | 13 | 13 | 8.5 | 17 | 6.5 | 14.5 | 10.5 | 0.014 |
| 6 | 3139 06 00 | 17 | 15 | 10.5 | 19.5 | 7 | 17.5 | 12.5 | 0.021 |
| 8 | 3139 08 00 | 19 | 18 | 13.5 | 24 | 8 | 23 | 15.5 | 0.032 |
| 10 | 3139 10 00 | 22 | 22 | 16 | 28 | 8.5 | 26 | 18.5 | 0.048 |
| 12 | 3139 12 00 | 24 | 26 | 19 | 33 | 8.5 | 31 | 22.5 | 0.084 |
| 14 | 3139 14 00 | 27 | 29 | 25.5 | 37.5 | 10.5 | 36 | 25.5 | 0.117 |

The body swivels for positioning purposes.

Boxes protect the contents and are designed to meet your requirements:

- part numbers and corresponding product pictures allow for immediate visual identification
- bar codes
- easy storage
- tamper-proof system of opening/closing
- recyclable material



3144 Equal and Unequal Multiple Y Piece

Technical polymer, NBR

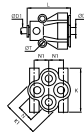

| ØD | ØD1 | | K | K1 | L | N | N1 | ØT | Kg |
|----|-----|-------------------|------|------|------|----|-----|-----|-------|
| 4 | 4 | 3144 04 04 | 25.5 | 21 | 30.5 | 10 | 8.5 | 3.7 | 0.015 |
| | 6 | 3144 04 06 | 25.5 | 21 | 30.5 | 10 | 8.5 | 3.7 | 0.013 |
| 6 | 6 | 3144 06 06 | 31.5 | 26.5 | 37.5 | 12 | 10 | 3.7 | 0.032 |
| | 8 | 3144 06 08 | 31.5 | 26.5 | 38 | 12 | 10 | 3.7 | 0.026 |

3304 Multiple Tee

Technical polymer, NBR

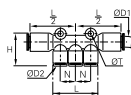

| ØD1 | ØD2 | | H | L | L/2 | N | ØT | Kg |
|-----|-----|-------------------|------|----|------|------|-----|-------|
| 6 | 4 | 3304 06 04 | 24.5 | 34 | 37 | 11.5 | 4.2 | 0.015 |
| 8 | 4 | 3304 08 04 | 24.5 | 34 | 37 | 11.5 | 4.2 | 0.012 |
| | 6 | 3304 08 06 | 24.5 | 34 | 37 | 11.5 | 4.2 | 0.010 |
| 10 | 6 | 3304 10 06 | 36 | 44 | 40.5 | 14.5 | 4.2 | 0.019 |
| | 8 | 3304 10 08 | 36 | 44 | 40.5 | 15.5 | 4.2 | 0.015 |

3306 90° Multiple Elbow

Technical polymer, NBR

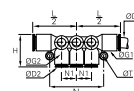

| ØD1 | ØD2 | | G | G1 | H | L/2 | N | N1 | ØT | Kg |
|-----|-----|-------------------|------|------|------|------|----|------|-----|-------|
| 6 | 4 | 3306 06 04 | 13.5 | 11 | 18.5 | 36 | 43 | 11.5 | 4.2 | 0.034 |
| 8 | 4 | 3306 08 04 | 13.5 | 11 | 18.5 | 36.5 | 43 | 11.5 | 4.2 | 0.025 |
| | 6 | 3306 08 06 | 13.5 | 11 | 18.5 | 36.5 | 43 | 11.5 | 4.2 | 0.022 |
| 10 | 6 | 3306 10 06 | 16 | 13.5 | 23 | 42 | 52 | 14.5 | 4.2 | 0.048 |
| | 8 | 3306 10 08 | 16 | 13.5 | 23.5 | 42 | 52 | 14.5 | 4.2 | 0.021 |

3310 In-Line Manifold

Treated aluminium, NBR

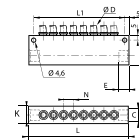

| ØD | C | | Number of Outlets | E | H | K | L | L1 | N | Kg |
|----|------|-------------------|-------------------|----|----|----|-------|-------|------|-------|
| 4 | G1/4 | 3310 04 13 | 8 | 10 | 33 | 20 | 114 | 104 | 11.5 | 0.164 |
| 6 | G1/4 | 3310 06 13 | 8 | 10 | 33 | 20 | 114 | 104 | 12.5 | 0.160 |
| 8 | G3/8 | 3310 08 17 | 6 | 12 | 33 | 20 | 114 | 104 | 15 | 0.149 |
| 10 | G1/2 | 3310 10 21 | 6 | 16 | 48 | 25 | 145.5 | 135.5 | 17 | 0.329 |
| 12 | G1/2 | 3310 12 21 | 4 | 16 | 45 | 25 | 158 | 148 | 20.5 | 0.354 |

Parker Legris offers the solution to enable many types of configuration options.

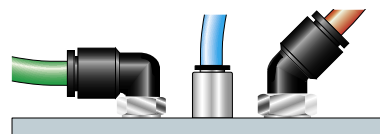

3182 Equal and Unequal Plug-In Elbow

Technical polymer, NBR

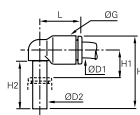

| ØD1 | ØD2 | | G | H | H1 | H2 | L | Kg |
|-----|-----|-------------------|------|------|------|------|------|-------|
| 4 | 4 | 3182 04 00 | 8.5 | 23 | 6 | 15.5 | 14 | 0.005 |
| 4 | 6 | 3182 04 06 | 10.5 | 26.5 | 7 | 17 | 16 | 0.004 |
| | 4 | 3182 06 04 | 10.5 | 24.5 | 7 | 15.5 | 16 | 0.001 |
| 6 | 6 | 3182 06 00 | 10.5 | 26.5 | 7 | 17 | 16 | 0.001 |
| | 8 | 3182 06 08 | 13.5 | 33.5 | 8 | 21.5 | 23 | 0.007 |
| 8 | 8 | 3182 08 00 | 13.5 | 33.5 | 8 | 21.5 | 23 | 0.003 |
| | 10 | 3182 08 10 | 16 | 39 | 10 | 24.5 | 26.5 | 0.010 |
| 10 | 10 | 3182 10 00 | 16 | 39 | 10 | 24.5 | 26.5 | 0.004 |
| | 12 | 3182 10 12 | 19 | 44.5 | 10.5 | 27.5 | 31 | 0.016 |
| 12 | 12 | 3182 12 00 | 19 | 45.5 | 10.5 | 27.5 | 31 | 0.007 |

The references in diameter 4mm and 12mm are not grooved in standard version

3180 45° Plug-In Equal Elbow

Technical polymer, NBR

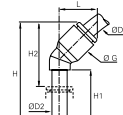

| ØD1 | ØD2 | | G | H | H1 | H2 | L | Kg |
|-----|-----|-------------------|------|------|------|------|------|-------|
| 4 | 4 | 3180 04 00 | 9 | 33.5 | 19 | 21 | 13 | 0.001 |
| 6 | 6 | 3180 06 00 | 11 | 39 | 21 | 25 | 14.5 | 0.002 |
| 8 | 8 | 3180 08 00 | 13.5 | 44 | 21.5 | 25.5 | 19.5 | 0.003 |
| 10 | 10 | 3180 10 00 | 16 | 53 | 27 | 32.5 | 23 | 0.004 |
| 12 | 12 | 3180 12 00 | 19 | 58.5 | 27.5 | 34 | 26.5 | 0.007 |

3182 Equal Plug-In Elbow

Inch

Technical polymer, NBR

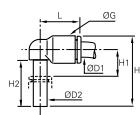

| ØD1 | ØD2 | | G | H | H1 | H2 | L | Kg |
|-----|-----|-------------------|----|------|-----|----|------|-------|
| 1/4 | 1/4 | 3182 56 00 | 11 | 27.5 | 7.5 | 18 | 18.5 | 0.002 |
| 3/8 | 3/8 | 3182 60 00 | 16 | 38.5 | 9 | 24 | 26 | 0.010 |

5/32"(4 mm) and 5/16"(8 mm) also available

3183 Equal and Unequal Plug-In Run Tee

Technical polymer, NBR

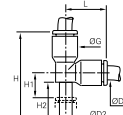

| ØD1 | ØD2 | | G | H | H1 | H2 | L | Kg |
|-----|-----|-------------------|------|------|------|------|------|-------|
| 4 | 4 | 3183 04 00 | 8.5 | 33 | 6 | 15.5 | 14.5 | 0.002 |
| | 6 | 3183 04 06 | 10.5 | 38.5 | 7 | 17 | 17.5 | 0.006 |
| 6 | 6 | 3183 06 00 | 10.5 | 38.5 | 7 | 17 | 17 | 0.002 |
| | 8 | 3183 06 08 | 13.5 | 48.5 | 8 | 21.5 | 23 | 0.014 |
| 8 | 8 | 3183 08 00 | 13.5 | 49 | 8 | 21.5 | 23 | 0.004 |
| | 10 | 3183 08 10 | 16 | 56.5 | 10.5 | 24.5 | 26.5 | 0.018 |
| 10 | 10 | 3183 10 00 | 16 | 57 | 10.5 | 24.5 | 26.5 | 0.007 |
| | 12 | 3183 10 12 | 19 | 65.5 | 10.5 | 27.5 | 31 | 0.034 |
| 12 | 12 | 3183 12 00 | 19 | 65.5 | 10.5 | 27.5 | 31 | 0.011 |

3184 Extended Equal and Unequal Plug-In Elbow

Technical polymer, NBR

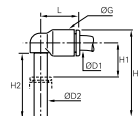

| ØD1 | ØD2 | | G | H | H1 | H2 | L | Kg |
|-----|-----|-------------------|------|------|------|------|------|-------|
| 4 | 4 | 3184 04 00 | 8.5 | 32.5 | 15.5 | 25 | 14 | 0.004 |
| | 6 | 3184 04 06 | 10.5 | 38.5 | 19 | 29 | 16 | 0.004 |
| 6 | 6 | 3184 06 00 | 10.5 | 38.5 | 19 | 29 | 16 | 0.002 |
| | 8 | 3184 06 08 | 13.5 | 49 | 23.5 | 37 | 23 | 0.007 |
| 8 | 8 | 3184 08 00 | 13.5 | 49 | 23.5 | 37 | 23 | 0.003 |
| | 10 | 3184 08 10 | 16 | 56 | 26.5 | 41.5 | 26.5 | 0.011 |
| 10 | 10 | 3184 10 00 | 16 | 56 | 26.5 | 41.5 | 26.5 | 0.005 |
| | 12 | 3184 10 12 | 19 | 62.5 | 28 | 45.5 | 31 | 0.017 |
| 12 | 12 | 3184 12 00 | 19 | 62.5 | 28 | 45.5 | 31 | 0.008 |

The references in diameter 4mm and 12mm are not grooved in standard version

3188 Equal and Unequal Plug-In Branch Tee

Technical polymer, NBR

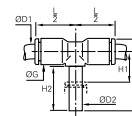

| ØD1 | ØD2 | | G | H | H1 | H2 | L/2 | Kg |
|-----|-----|-------------------|------|------|------|------|------|-------|
| 4 | 4 | 3188 04 00 | 8.5 | 25 | 8 | 15.5 | 14.5 | 0.001 |
| | 6 | 3188 04 06 | 10.5 | 28.5 | 9 | 17 | 16 | 0.007 |
| 6 | 6 | 3188 06 00 | 10.5 | 28.5 | 9 | 17 | 16 | 0.002 |
| | 8 | 3188 06 08 | 13.5 | 36.5 | 11 | 21.5 | 22 | 0.014 |
| 8 | 8 | 3188 08 00 | 13.5 | 36.5 | 11 | 21.5 | 23 | 0.004 |
| | 10 | 3188 08 10 | 16 | 41 | 12.5 | 24.5 | 26.5 | 0.018 |
| 10 | 10 | 3188 10 00 | 16 | 41 | 12.5 | 24.5 | 26.5 | 0.007 |
| | 12 | 3188 10 12 | 19 | 46.5 | 12.5 | 27.5 | 31 | 0.030 |
| 12 | 12 | 3188 12 00 | 19 | 46.5 | 12.5 | 27.5 | 31 | 0.012 |

3142 Equal and Unequal Plug-In Single Y Piece

Technical polymer, NBR

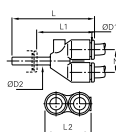

| ØD1 | ØD2 | | L | L1 | L2 | N | Kg |
|-----|-----|-------------------|------|------|------|------|-------|
| 4 | 4 | 3142 04 00 | 34 | 21.5 | 17.5 | 9 | 0.002 |
| | 6 | 3142 04 06 | 35.5 | 21.5 | 17.5 | 9 | 0.002 |
| 6 | 6 | 3142 06 00 | 39.5 | 25.5 | 21.5 | 11 | 0.004 |
| | 8 | 3142 06 08 | 44.5 | 26 | 22 | 11 | 0.006 |
| 8 | 8 | 3142 08 00 | 50.5 | 32 | 28 | 14.5 | 0.007 |
| | 10 | 3142 08 10 | 53.5 | 32 | 28 | 14.5 | 0.022 |
| 10 | 10 | 3142 10 00 | 57.5 | 36 | 33 | 17 | 0.010 |
| | 12 | 3142 10 12 | 60 | 35 | 33 | 17 | 0.035 |
| 12 | 12 | 3142 12 00 | 66 | 41 | 39 | 20 | 0.017 |

3143 Multiple Plug-In Y Piece

Technical polymer, Nickel-plated brass, NBR

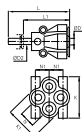

| ØD1 | ØD2 | | K | K1 | L | L1 | N | N1 | Kg |
|-----|-----|-------------------|------|------|------|------|----|-----|-------|
| 4 | 6 | 3143 04 06 | 26 | 21.5 | 49.5 | 35.5 | 11 | 8.5 | 0.018 |
| | 8 | 3143 04 08 | 26 | 21.5 | 51 | 32 | 11 | 8.5 | 0.021 |
| 6 | 8 | 3143 06 08 | 31.5 | 26.5 | 57.5 | 39 | 12 | 10 | 0.035 |

3120 Stem Connector

Technical polymer

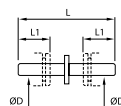

| ØD | | L | L1 | Kg |
|----|-------------------|------|------|-------|
| 4 | 3120 04 00 | 34.5 | 12 | 0.001 |
| 6 | 3120 06 00 | 38.5 | 14 | 0.001 |
| 8 | 3120 08 00 | 41 | 18.5 | 0.001 |
| 10 | 3120 10 00 | 51.5 | 20.5 | 0.002 |
| 12 | 3120 12 00 | 60 | 24.5 | 0.004 |
| 14 | 3120 14 00 | 69.5 | 25.5 | 0.007 |

This model exists in nickel-plated brass; please use suffix 85. Example: 3120 06 00 85
Only compatible with Parker Legris fittings. Drawing available upon request.

3166 Plug-In Reducer

Technical polymer, NBR

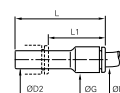

| ØD1 | ØD2 | | G | L | L1 | Kg |
|-----|-----|-------------------|------|------|------|-------|
| 3 | 4 | 3166 03 04 | 8.5 | 37.5 | 23.5 | 0.002 |
| | 6 | 3166 04 06 | 8.5 | 37.5 | 23.5 | 0.001 |
| 4 | 8 | 3166 04 08 | 8.5 | 37.5 | 19 | 0.001 |
| | 10 | 3166 04 10 | 10.5 | 38 | 18 | 0.003 |
| 6 | 8 | 3166 06 08 | 10.5 | 37.5 | 20 | 0.001 |
| | 10 | 3166 06 10 | 10.5 | 38 | 17.5 | 0.002 |
| 8 | 12 | 3166 08 12 | 14.5 | 46 | 23 | 0.005 |
| | 14 | 3166 08 14 | 14.5 | 48 | 23 | 0.007 |
| 10 | 10 | 3166 10 10 | 13.5 | 49 | 28.5 | 0.003 |
| | 12 | 3166 10 12 | 13.5 | 49 | 24.5 | 0.004 |
| 12 | 14 | 3166 12 14 | 17 | 48 | 23 | 0.007 |
| | 12 | 3166 12 12 | 21.5 | 56.5 | 33.5 | 0.005 |
| 14 | 14 | 3166 14 14 | 21.5 | 58.5 | 33.5 | 0.005 |
| | 12 | 3166 14 12 | 23.5 | 58.5 | 33.5 | 0.007 |

3166 Plug-In Reducer

Inch

Technical polymer, NBR

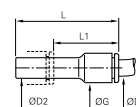

| ØD1 | ØD2 | | G | L | L1 | Kg |
|-----|------|-------------------|----|----|----|-------|
| 1/4 | 5/16 | 3166 56 08 | 11 | 41 | 23 | 0.002 |
| | 3/8 | 3166 56 60 | 11 | 41 | 21 | 0.002 |

3168 Plug-In Increaser

Technical polymer, NBR

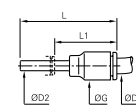

| ØD1 | ØD2 | | G | L | L1 | Kg |
|-----|-----|-------------------|------|------|------|-------|
| 6 | 4 | 3168 06 04 | 10.5 | 35 | 23 | 0.002 |
| | 6 | 3168 08 06 | 13.5 | 45 | 31.5 | 0.003 |
| 8 | 1/4 | 3168 08 56 | 16 | 40 | 25.5 | 0.009 |
| | 8 | 3168 10 08 | 16 | 42.5 | 21 | 0.004 |
| 12 | 10 | 3168 12 10 | 19 | 49 | 24.5 | 0.006 |

3168 Plug-In Increaser

Inch

Technical polymer, NBR

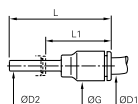

| ØD1 | ØD2 | | G | L | L1 | Kg |
|-----|------|-------------------|------|----|----|-------|
| 1/4 | 3/16 | 3168 56 55 | 20.5 | 41 | 25 | 0.002 |
| | 5/32 | 3168 56 04 | 11 | 41 | 29 | 0.002 |

3126 Blanking Plug

Technical polymer

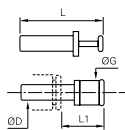

| ØD | | G | L | L1 | Kg |
|----|--------------------|----|----|------|-------|
| 3 | 3126 03 00 | 6 | 25 | 13.5 | 0.001 |
| 4 | 3126 04 00 | 4 | 30 | 15.5 | 0.001 |
| 6 | 3126 06 00 | 8 | 33 | 16.5 | 0.001 |
| 8 | 3126 08 00 | 10 | 35 | 17.5 | 0.001 |
| 10 | 3126 10 00 | 12 | 42 | 21 | 0.002 |
| 12 | 3126 12 00 | 14 | 45 | 22 | 0.003 |
| 14 | 3126 14 00 | 16 | 49 | 23.5 | 0.005 |
| 16 | 3126 16 00* | 19 | 57 | 30 | 0.064 |

*Nickel-plated brass

3126 Blanking Plug

Inch

Technical polymer

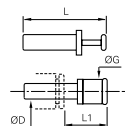

| ØD | | G | L | L1 | Kg |
|-----|-------------------|----|------|------|-------|
| 1/4 | 3126 56 00 | 8 | 36.5 | 22 | 0.001 |
| 3/8 | 3126 60 00 | 12 | 42 | 22 | 0.002 |
| 1/2 | 3126 62 00 | 15 | 48.5 | 21.5 | 0.003 |

5/32"(4 mm) and 5/16"(8 mm) also available

3122 Plug-In Barb Connector

Technical polymer

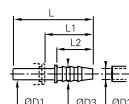

| ØD1 | ØD2 | ØD3 | | L | L1 | L2 | Kg |
|-----|------|------|-------------------|------|------|------|-------|
| 4 | 3.2 | 5 | 3122 04 53 | 37 | 25 | 17 | 0.004 |
| | 5 | 7 | 3122 04 05 | 37 | 25 | 17 | 0.001 |
| 6 | 5 | 7 | 3122 06 05 | 39 | 25 | 17 | 0.001 |
| 8 | 6.3 | 8.5 | 3122 08 56 | 39.5 | 21 | 17 | 0.001 |
| | 8 | 10 | 3122 08 08 | 44.5 | 26 | 22 | 0.001 |
| 10 | 6.3 | 8 | 3122 10 56 | 45 | 24.5 | 17 | 0.002 |
| | 8 | 10 | 3122 10 08 | 50 | 29.5 | 22 | 0.002 |
| 12 | 8 | 10 | 3122 12 08 | 50 | 26 | 22 | 0.002 |
| | 10 | 12 | 3122 12 10 | 48.5 | 25.5 | 22.5 | 0.002 |
| 14 | 12.5 | 14.5 | 3122 12 62 | 57 | 34 | 22.5 | 0.004 |
| | 12.5 | 14.5 | 3122 14 62 | 59.5 | 34.5 | 22.5 | 0.006 |

3151 End Cap

Technical polymer, NBR

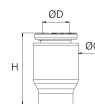

| ØD | | G | H | Kg |
|----|-------------------|------|----|-------|
| 4 | 3151 04 00 | 8.5 | 15 | 0.001 |
| 6 | 3151 06 00 | 10.5 | 17 | 0.001 |
| 8 | 3151 08 00 | 13.5 | 22 | 0.002 |
| 10 | 3151 10 00 | 16 | 22 | 0.003 |
| 12 | 3151 12 00 | 19 | 28 | 0.005 |
| 14 | 3151 14 00 | 22 | 31 | 0.009 |