

LIQUIfit® Push-in Fittings with Stainless Steel Adaptor



Made of nickel-plated brass or stainless steel, the metal base reinforces the installation of the fitting.

Ø metric:
4 to 16 mm

Technical Characteristics

- **Compatible Fluids:** Water, beverages, industrial fluids: stainless steel threads
Industrial fluids: FDA chemical nickel-plated brass threads
- **Working Pressure:** Vacuum to 16 bar
- **Working Temperature:** -10°C to +130°C (up to 10 bar) for O.D. 4, 6, 8 mm
-10°C to +95°C for all other products

Tightening Torques (BSPP)	Thread	M5 X0.8	G1/8	G1/4	G3/8	G1/2
	daN.m	0.16	0.8	1.2	3	3.5

Reliable performance is dependent upon the type of fluid conveyed, component materials and tubing being used.
Use is guaranteed with a vacuum of 755 mm Hg (99% vacuum).

Advantages

- Increased mechanical resistance to tightening
- Compliance with FDA and NSF standards in stainless steel version
- Chemical and mechanical resistance, at high temperature (up to 130°C)
- Bisphenol and phthalate-free

Regulations

- **RoHS**
- **REACH**
- **FDA:** 21 CFR
- **1935/2004**
- **DM 174**
- **ACS**
- **WRAS**
- **KTW** (stainless steel only)
- **W270** (stainless steel only)

Component Materials

Silicone-free

Body:
bio-based polymer

Adaptor:
stainless steel 316L or FDA chemical nickel-plated brass

Grey release button:
technical polymer

Gripping ring:
stainless steel

Seals: EPDM

Performance

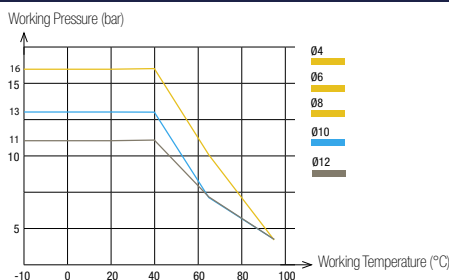

6911 Stud Fitting, Male BSPP and Metric Thread

Stainless steel 316L, EPDM

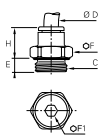

ØD	C		E	F	F1	H	Kg
4	M5x0.8	6911 04 19	3	10	2.5	14	0.006
	G1/8	6911 04 10	4.5	13	3	11.5	0.007
	G1/4	6911 04 13	5.5	16	3	10.5	0.011
6	M5x0.8	6911 06 19	3	11	2.5	16	0.005
	G1/8	6911 06 10	4.5	13	4	13	0.007
	G1/4	6911 06 13	5.5	16	4	12.5	0.011
8	G1/8	6911 08 10	4.5	13	5	20.5	0.011
	G1/4	6911 08 13	5.5	16	6	19.5	0.016
	G3/8	6911 08 17	5.5	21	6	18	0.022
10	G1/4	6911 10 13	5.5	16	7	23	0.018
	G3/8	6911 10 17	5.5	21	8	19.5	0.021
	G1/2	6911 10 21	7	24	8	18	0.033
12	G3/8	6911 12 17	5.5	21	9	27	0.029
	G1/2	6911 12 21	7	24	10	22.5	0.035
	G3/4	6911 16 17	7.5	27	9	32.5	0.060
16	G1/2	6911 16 21	9	27	12	32.5	0.063
	G3/4	6911 16 27	7.5	32	12	32.5	0.096

6975 Stud Fitting, Male BSPT Thread

Stainless steel 316L, EPDM

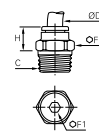

ØD	C		F	F1	H	Kg
4	R1/8	6975 04 10	10	3	9.5	0.005
	R1/4	6975 04 13	14	3	6.5	0.012
6	R1/8	6975 06 10	10	4	11.5	0.005
	R1/4	6975 06 13	14	4	8.5	0.011
8	R1/8	6975 08 10	13	5	20	0.011
	R1/4	6975 08 13	14	6	17	0.014
10	R3/8	6975 08 17	17	6	13	0.021
	R1/4	6975 10 13	16	7	20	0.017
12	R3/8	6975 10 17	17	8	16.5	0.019
	R1/2	6975 10 21	21	8	14	0.037
16	R3/8	6975 12 17	19	9	24	0.028
	R1/2	6975 12 21	21	10	19.5	0.036

6959 Stud Elbow, Male BSPP and Metric Thread

Bio-based polymer, stainless steel 316L, EPDM

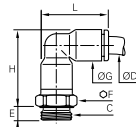

ØD	C		E	F	G	H	L	Kg
4	M5x0.8	6959 04 19	3.5	10	8.5	23	19	0.009
	G1/8	6959 04 10	4.5	13	8.5	22.5	19	0.009
	G1/4	6959 04 13	5.5	16	8.5	22.5	19	0.014
6	M5x0.8	6959 06 19	3.5	10	10.5	26.5	22.5	0.008
	G1/8	6959 06 10	4.5	13	10.5	26.5	22.5	0.011
	G1/4	6959 06 13	5.5	16	10.5	26.5	22.5	0.016
8	G1/8	6959 08 10	4.5	13	13.5	35	29.5	0.018
	G1/4	6959 08 13	5.5	16	13.5	33	29.5	0.020
	G3/8	6959 08 17	5.5	21	13.5	33	29.5	0.028
10	G1/4	6959 10 13	5.5	16	16	40.5	34	0.029
	G3/8	6959 10 17	5.5	21	16	39	34	0.037
	G1/2	6959 10 21	7	24	16	39	34	0.042
12	G1/4	6959 12 13	5.5	19	19	44	40	0.042
	G3/8	6959 12 17	5.5	21	19	42	40	0.040
	G1/2	6959 12 21	7	24	19	42	40	0.049
16	G3/8	6959 16 17	7.5	27	27	54	52	0.088
	G1/2	6959 16 21	9	27	27	55	52	0.084
	G3/4	6959 16 27	10.5	32	27	55	52	0.120

The body swivels for positioning purposes.

6979 Stud Elbow, Male BSPT Thread

Bio-based polymer, stainless steel 316L, EPDM

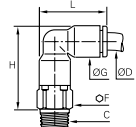

ØD	C		F	G	H	L	Kg
4	R1/8	6979 04 10	10	8.5	23	19	0.008
	R1/4	6979 04 13	14	8.5	23.5	19	0.018
6	R1/8	6979 06 10	10	10.5	27	22.5	0.010
	R1/4	6979 06 13	14	10.5	27.5	22.5	0.020
8	R1/8	6979 08 10	13	13.5	33.5	29.5	0.018
	R1/4	6979 08 13	14	13.5	32.5	29.5	0.022
	R3/8	6979 08 17	17	13.5	33	29.5	0.032
	R1/4	6979 10 13	15	16	39.5	34	0.031
10	R3/8	6979 10 17	17	16	39.5	34	0.041
	R1/2	6979 10 21	21	16	39.5	34	0.060
12	R3/8	6979 12 17	19	19	45.5	40.5	0.051
	R1/2	6979 12 21	21	19	45.5	40.5	0.065

The body swivels for positioning purposes.

6974 Stud Fitting, Female BSPP Thread

Stainless steel 316L, EPDM

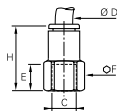

ØD	C		E	F	H	Kg
G3/8	6974 16 17		17	27	44	0.060
16	G1/2	6974 16 21	21.5	27	17	0.065
	G3/4	6974 16 27	19	32	47	0.097

6958 Stud Branch Tee, Male BSPP and Metric Thread

Bio-based polymer, stainless steel 316L, EPDM

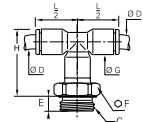

ØD	C		E	F	G	H	L/2	Kg
4	G1/8	6958 04 10	5	13	8.5	22	14	0.009
	G1/4	6958 04 13	5.5	16	8.5	22	14	0.014
6	G1/8	6958 06 10	5	13	10.5	28.5	16	0.011
	G1/4	6958 06 13	5.5	16	10.5	28.5	16	0.016
8	G1/8	6958 08 10	4.5	13	13.5	38	23	0.019
	G3/8	6958 08 17	5.5	21	13.5	36	23	0.030
	G1/4	6958 10 13	5.5	16	16	43	26.5	0.032
	G3/8	6958 10 17	5.5	21	16	43	26.5	0.055
10	G1/2	6958 10 21	7.5	24	16	43	26.5	0.051
	G3/8	6958 12 17	5.5	21	19	45.5	31	0.042
12	G1/2	6958 12 21	7	24	19	45.5	31	0.049

The body swivels for positioning purposes.

6978 Stud Branch Tee, Male BSPT Thread

Bio-based polymer, stainless steel 316L, EPDM

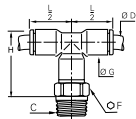

ØD	C		F	G	H	L/2	Kg
4	R1/8	6978 04 10	10	8.5	17	14	0.009
	R1/4	6978 04 13	14	8.5	17	14	0.020
6	R1/8	6978 06 10	10	10.5	23	16	0.011
	R1/4	6978 06 13	14	10.5	23	16	0.011
8	R1/8	6978 08 10	13	13.5	30	23	0.020
	R1/4	6978 08 13	14	13.5	30	23	0.025
	R3/8	6978 08 17	17	13.5	30	23	0.036
10	R1/4	6978 10 13	15	16	34.5	26.5	0.033
	R3/8	6978 10 17	17	16	34.5	26.5	0.043
	R1/2	6978 10 21	21	16	34.5	26.5	0.065
12	R3/8	6978 12 17	19	19	40.5	31	0.053
	R1/2	6978 12 21	21	19	40.5	31	0.061

6973 Stud Run Tee, Male BSPT Thread

Bio-based polymer, stainless steel 316L, EPDM

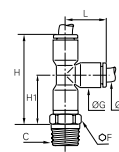

ØD	C		F	G	H	H1	L	Kg
4	R1/8	6973 04 10	10	8.5	31	18	14.5	0.009
	R1/4	6973 04 13	14	8.5	31	19	14.5	0.020
6	R1/8	6973 06 10	10	10.5	38	22	17.5	0.011
	R1/4	6973 06 13	14	10.5	39	23	17.5	0.011
8	R1/8	6973 08 10	13	13.5	53	30	23	0.020
	R1/4	6973 08 13	14	13.5	52	29	23	0.025
	R3/8	6973 08 17	17	13.5	52	29	23	0.036
10	R1/4	6973 10 13	15	16	61	35	26.5	0.033
	R3/8	6973 10 17	17	16	61	35	26.5	0.043
	R1/2	6973 10 21	21	16	61	35	26.5	0.065
12	R3/8	6973 12 17	19	19	70	39	31	0.053
	R1/2	6973 12 21	21	19	70	39	31	0.061

6953 Stud Run Tee, Male BSPP and Metric Thread

Bio-based polymer, stainless steel 316L, EPDM

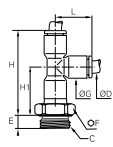

ØD	C		E	F	G	H	H1	L	Kg
4	G1/8	6953 04 10	5	13	8.5	30	18	14.5	0.009
	G1/4	6953 04 13	5.5	16	8.5	30	18	14.5	0.014
6	G1/8	6953 06 10	5	13	10.5	38	22	17.5	0.011
	G1/4	6953 06 13	5.5	16	10.5	38	22	17.5	0.016
8	G1/4	6953 08 13	5.5	16	13.5	52	29	23	0.022
	G3/8	6953 08 17	5.5	21	13.5	52	29	23	0.030
	G1/4	6953 10 13	5.5	16	16	61	35	26.5	0.032
10	G3/8	6953 10 17	5.5	21	16	61	35	26.5	0.055
	G1/2	6953 10 21	7.5	24	16	61	35	26.5	0.051
12	G3/8	6953 12 17	5.5	21	19	67	36	31	0.042
	G1/2	6953 12 21	7	24	19	67	36	31	0.049

Complementary Products for LIQUIfit® with Stainless Steel Adaptors

Technical Tubing and Hose

Advanced PE

FEP

PFA

