

AP SAE Flange locking plate

ISO 6162-1/-2

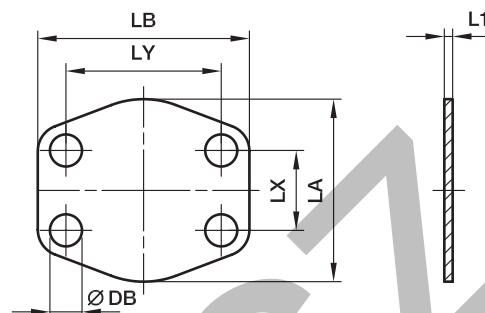

3000 PSI Series

Nom. flange size		L1	LA	LB	LX	LY	DB	Weight (steel) kg/piece	Order code*	PN (bar)	
SAE (in.)	ISO (DN)									CF	SS
1/2	13	3	47	57	17.5	38.1	9.0	0.05	8AP1	—	—
3/4	19	3	49	66	22.3	47.6	11.0	0.06	12AP1	—	—
1	25	3	59	71	26.2	52.4	11.0	0.07	16AP1	—	—
1 1/4	32	3	69	80	30.2	58.7	11.5	0.10	20AP1	—	—
1 1/2	38	3	77	95	35.7	69.9	13.5	0.15	24AP1	—	—
2	51	3	97	103	42.9	77.8	13.5	0.19	32AP1	—	—
2 1/2	64	3	109	116	50.8	89.9	13.5	0.22	40AP1	—	—
3	76	4	131	136	61.9	106.4	17.0	0.40	48AP1	—	—
3 1/2	89	4	136	152	69.9	102.7	17.0	0.53	56AP1	—	—
4	102	4	146	162	77.8	130.2	17.0	0.61	64AP1	—	—
5	127	4	181	184	92.1	152.4	17.0	0.86	80AP1	—	—

6000 PSI Series

1/2	13	4	48	57	18.2	40.5	9.0	0.02	8AP2	—	—
3/4	19	4	60	71	23.8	50.8	11.0	0.10	12AP2	—	—
1	25	4	70	81	27.8	57.2	13.0	0.12	16AP2	—	—
1 1/4	32	4	78	95	31.8	66.6	15.0	0.17	20AP2	—	—
1 1/2	38	4	95	113	36.5	79.4	17.0	0.22	24AP2	—	—
2	51	4	117	135	44.5	96.8	21.0	0.36	32AP2	—	—
2 1/2	64	4	150	176	58.7	123.8	25.0	0.58	40AP2	—	—
3	76	4	178	210	71.4	152.4	32.0	0.86	48AP2	—	—

This flange locking plate is not used under pressure.

Stainless steel parts may have dimensional deviations. Additional information on request.

*Please add the **suffixes** below according to the material/surface required.

Order code suffixes			
Material	Suffix surface and material	Example	Description
Steel, zinc plated, Cr(VI)-free	CF	8AP1CF	only locking plate
Stainless steel	SS	8AP1SS	only locking plate