

## PNMK4 Plug

BSPP 60° Cone plug (ISO 8434-6)

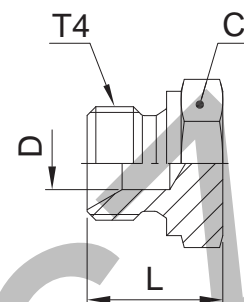

Thread BSPP T4	C mm	D mm	L mm	Weight (steel) g/1 piece	Adapter Steel	Adapter Stainless Steel	PN (bar)	
							S	SS
1/8-28	14	3.5	14	11	<b>2PNMK4S</b>	<b>2PNMK4SS</b>	350	350
1/4-19	19	4.7	19	22	<b>4PNMK4S</b>	<b>4PNMK4SS</b>	350	350
3/8-19	22	7.9	21	38	<b>6PNMK4S</b>	<b>6PNMK4SS</b>	350	350
1/2-14	27	11.1	24	66	<b>8PNMK4S</b>	<b>8PNMK4SS</b>	200	200
5/8-14	30	14.3	27	76	<b>10PNMK4S</b>	<b>10PNMK4SS</b>	200	200
3/4-14	32	16.7	27	106	<b>12PNMK4S</b>	<b>12PNMK4SS</b>	200	200
1-11	41	22.2	30	170	<b>16PNMK4S</b>	<b>16PNMK4SS</b>	120	120
1 1/4-11	50	28.6	39	316	<b>20PNMK4S</b>	<b>20PNMK4SS</b>	105	105
1 1/2-11	55	33.3	43	386	<b>24PNMK4S</b>	<b>24PNMK4SS</b>	105	105
2-11	70	46.0	48	650	<b>32PNMK4S</b>	<b>32PNMK4SS</b>	70	70

Order codes shown are part of our current manufacturing programme.

Imperial and metric parts may vary in hexagon dimensions.

$$\frac{\text{PN (bar)}}{10} = \text{PN (MPa)}$$

Do not create drawings from these dimensions, they are subject to change and ISO manufacturing allowances.