

192EX – Sealing Head (60°) BSP Swivel Nut

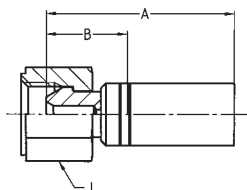

EX Series

Part No. #	DN	size	mm	inch	Connection Type Thread Size	A mm	B mm	J mm
192EX-4-025	4	-025	4.0	5/32	G 1/4	39	17	17
192EX-6-025	4	-025	4.0	5/32	G 3/8	40	18	19

Material: Steel, surface protection according to DIN 50 961 Fe/Zn, special materials available upon request

1D9EX – BSP Male DIN 3852 Shape A

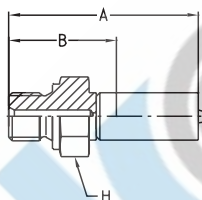

EX Series

Part No. #	DN	size	mm	inch	Connection Type Thread Size	A mm	B mm	H mm
1D9EX-4-012	2	-012	2.0	5/64	G 1/4	40	29	19

Material: Steel, surface protection according to DIN 50 961 Fe/Zn, special materials available upon request

1BPEX – Female BSP Rigid

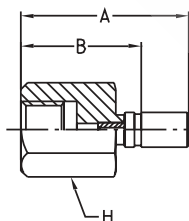

EX Series

Part No. #	DN	size	mm	inch	Connection Type Thread Size	A mm	B mm	H mm
1BPEX-4-012	2	-012	2.0	5/64	G 1/4	39	28	19

Material: Steel, surface protection according to DIN 50 961 Fe/Zn, special materials available upon request